

# SADDLEWORTH SCHOOL - HIGHWAY PROPOSALS

## OPTION B - PRIORITISED TRAFFIC FLOW WITH TRAFFIC LIGHTS

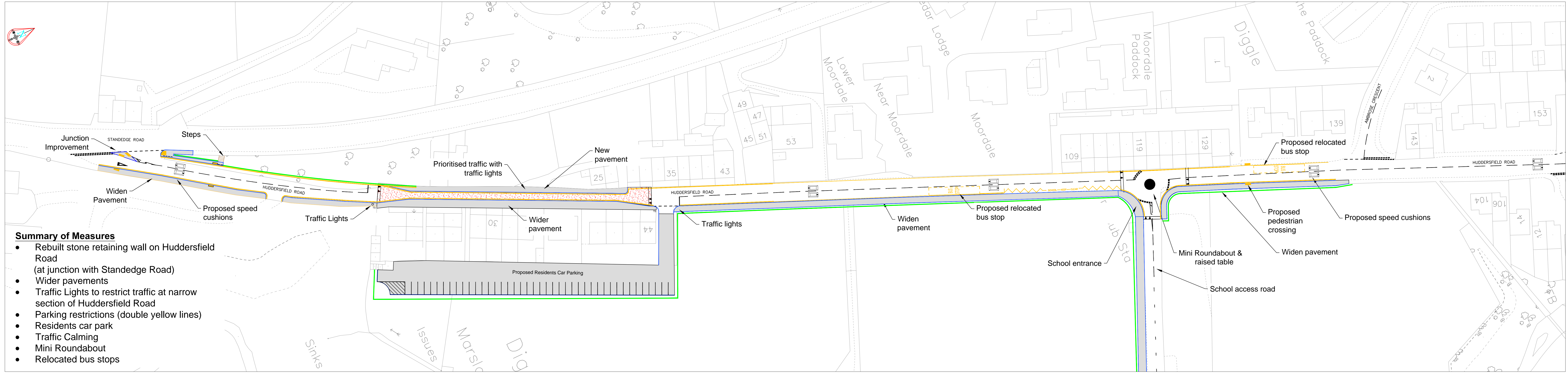

- Summary of Measures**
- Rebuilt stone retaining wall on Huddersfield Road (at junction with Standedge Road)
  - Wider pavements
  - Traffic Lights to restrict traffic at narrow section of Huddersfield Road
  - Parking restrictions (double yellow lines)
  - Residents car park
  - Traffic Calming
  - Mini Roundabout
  - Relocated bus stops