

01/506

IMPORTANT - THIS COMMUNICATION AFFECTS YOUR PROPERTY

**TOWN AND COUNTRY PLANNING ACT 1990
(as amended by the Planning and Compensation Act 1991)**

ENFORCEMENT NOTICE

COPY

ISSUED BY: OLDHAM BOROUGH COUNCIL ("the Council")

1. THIS IS A FORMAL NOTICE which is issued by the Council because it appears to them that there has been a breach of planning control, under section 171A(1)(a) of the above Act, at the land described below. They consider that it is expedient to issue this notice, having regard to the provisions of the development plan and to other material planning considerations.

2. THE LAND AFFECTED

The land situate at Prospect House, George Street, Shaw, Oldham shown edged red on the attached plan ("the land").

3. THE BREACH OF PLANNING CONTROL ALLEGED

Without planning permission, the stationing of a steel container in the position hatched red on the attached plan.

4. REASONS FOR ISSUING THIS NOTICE

It appears to the Council that the above breach of planning control has occurred within the last four years. The siting of the steel container close to residential properties has a detrimental effect on the visual and residential amenity of the surrounding area, and as such is contrary to the provisions of Policy BE1.1 of the Council's Unitary Development Plan. The Council does not consider that planning permission should be given for the unauthorised development because planning conditions could not overcome these problems.

5. WHAT YOU ARE REQUIRED TO DO

Remove the steel container from the land.

Time for Compliance: Two months after this notice takes effect.

6. WHEN THIS NOTICE TAKES EFFECT

This notice takes effect on 15th July 2003 unless an appeal is made against it beforehand.

Dated: 3rd June 2003

Signed

ANGELA B HARWOOD
SOLICITOR TO THE COUNCIL
Council's authorised officer

on behalf of

OLDHAM BOROUGH COUNCIL
CIVIC CENTRE
WEST STREET
OLDHAM OL1 1UL

YOUR RIGHT OF APPEAL

You can appeal against this notice, but any appeal must be received, or posted in time to be received, by the Secretary of State before the 15th July 2003. The enclosed booklet "Enforcement Appeals - A Guide to Procedure" sets out your rights. Read it carefully. You may use the enclosed appeal forms. One is for you to send to the Secretary of State if you decide to appeal, one is for you to keep as a duplicate for your own records, and one is to be forwarded to the Local Authority. You should also send the Secretary of State the spare copy of this enforcement notice which is enclosed.

WHAT HAPPENS IF YOU DO NOT APPEAL

If you do not appeal against this enforcement notice, it will take effect on the 15th July 2003 and you must then ensure that the required steps for complying with it, for which you may be held responsible, are taken within the period(s) specified in the notice. Failure to comply with an enforcement notice which has taken effect can result in prosecution and/or remedial action by the Council.

Doc Ref: legal/3091/14gonojh3m(1)

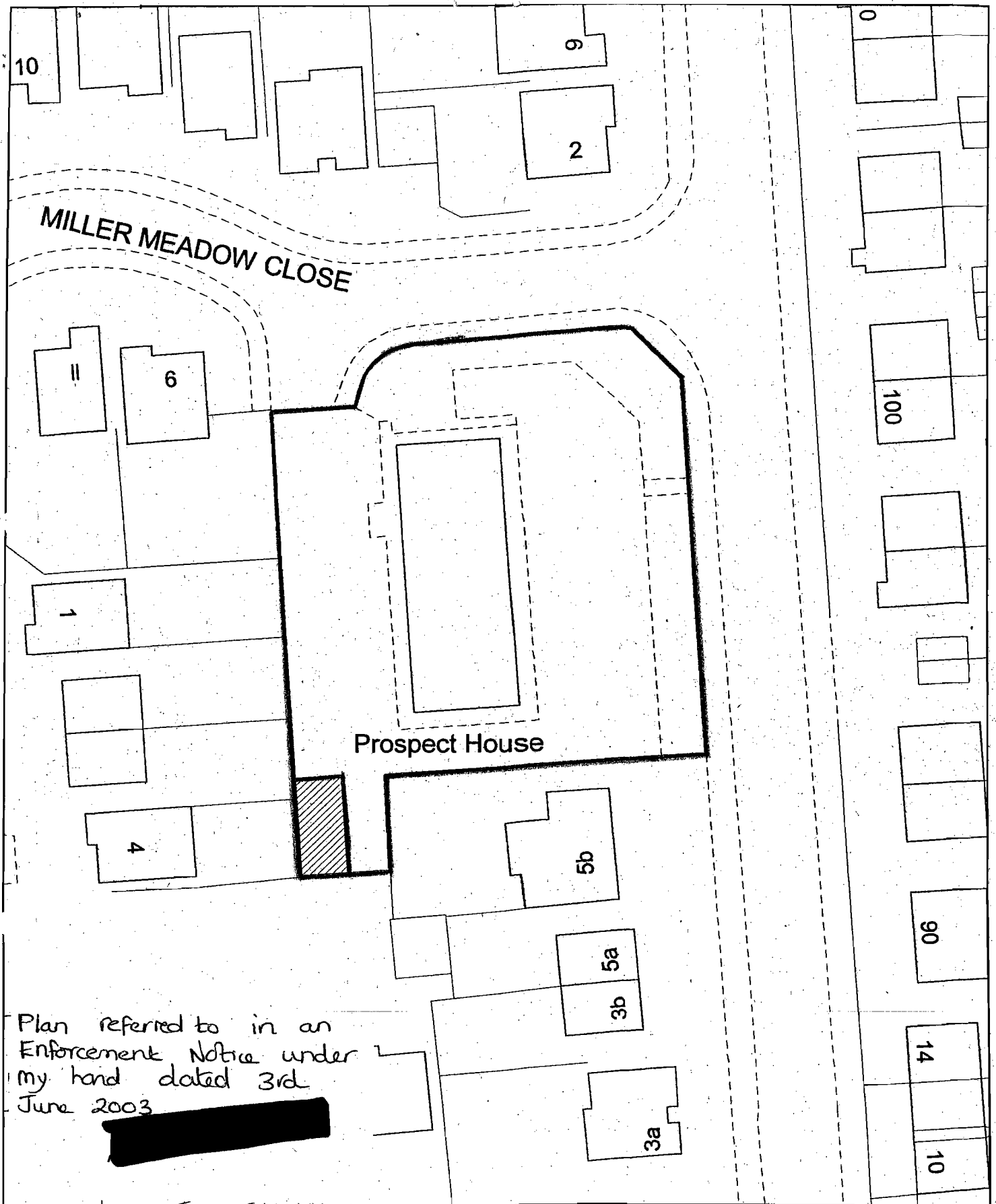

Plan referred to in an
 Enforcement Notice under
 my hand dated 3rd
 June 2003
 [Redacted Name]

ENFORCEMENT NOTICE

Unauthorised Siting of Steel Container (hatched red)

DCT Civil Engineering,
 Prospect House,
 George Street,
 Shaw, Oldham



1:500 SD9409NW 04/12/2002

OLDHAM 
 Metropolitan Borough 

Environment & Transportation

Acting Executive Director John Hurst
 Civic Centre PO Box 30 West Street Oldham OL1 1UQ

Explanatory Note relating to an Enforcement Notice dated 3rd June, 2003 in respect of Prospect House, George Street, Shaw, Oldham.

The fee payable for the deemed application for planning permission was £220.00.

A copy of the enforcement notice has been served on the following :-

1. DCT Civil Engineering Limited, Prospect House, George Street, Shaw, Oldham
2. Derek Cyril Thompson, 5th Floor, St Johns Chambers, St John Street, Manchester
3. Christine Thompson, 5th Floor, St Johns Chambers, St John Street, Manchester
4. Paul Frederick Thompson, 5th Floor, St Johns Chambers, St John Street, Manchester
5. Charter House Trustees Limited, Charter House, Woodlands Road, Altrincham