

In the 2006 UDP, policy CF1.1 identified two education facilities for development. These allocations were CF1.1.1 Blackshaw Lane, Heyside (Replacement School) and CF1.1.2 Platting Road, Lydgate (New Playing Fields). Both have now been developed for their intended purpose and therefore are not carried forward through the LDF. Table 25 of the joint DPD shows the UDP policies that will be superseded once the joint DPD has been adopted which includes policy CF1.1. We have also prepared a draft LDF proposals map which shows all the consequential changes from the UDP proposals map. In addition to this Table 23 of the joint DPD Appendices document includes a set of A4 inset maps showing map changes from the 2006 UDP. Overleaf are inset maps of the two education facilities.

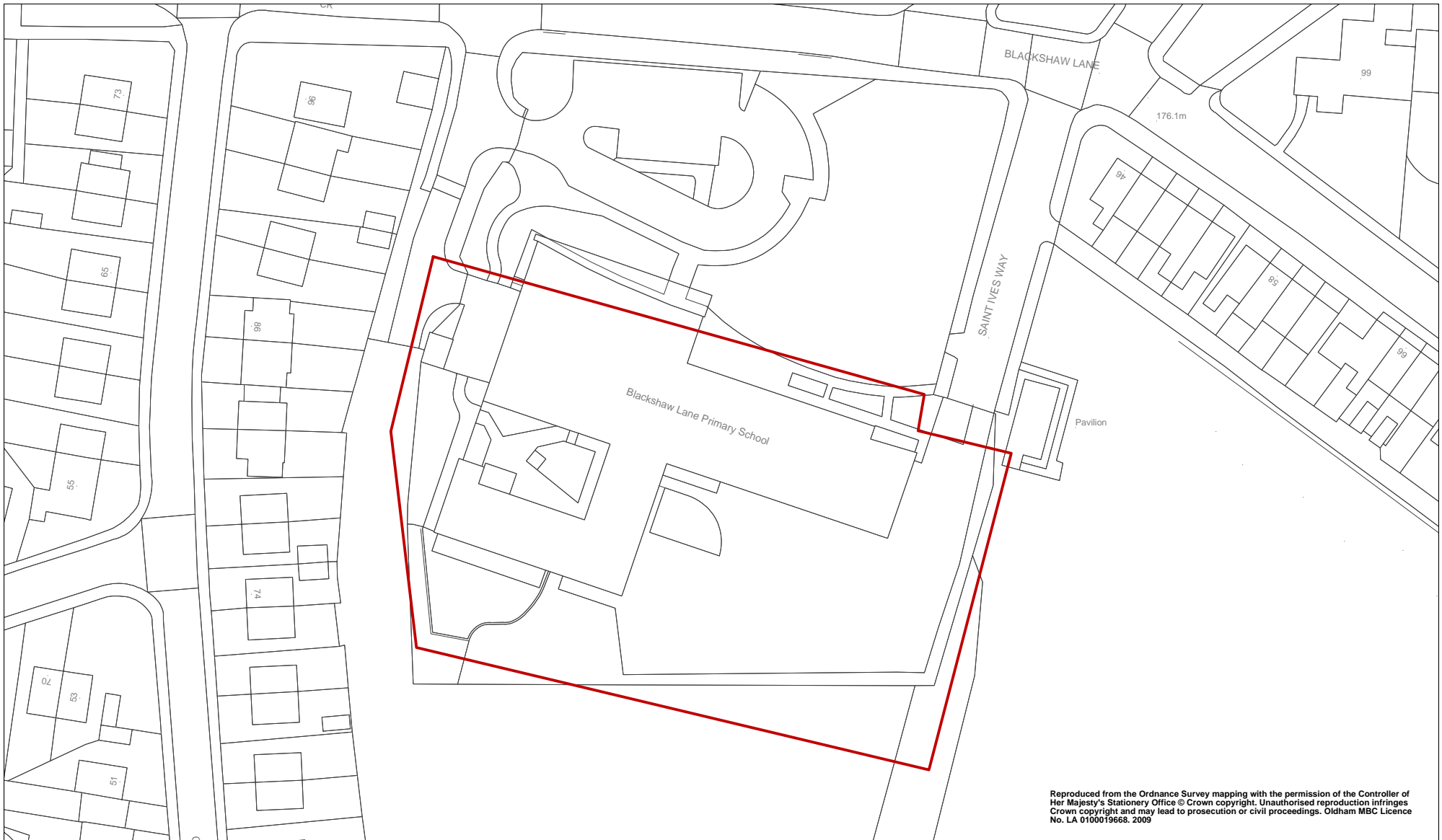

Reproduced from the Ordnance Survey mapping with the permission of the Controller of Her Majesty's Stationery Office © Crown copyright. Unauthorised reproduction infringes Crown copyright and may lead to prosecution or civil proceedings. Oldham MBC Licence No. LA 0100019668. 2009

2006 UDP Policy CF1.1.1 Blackshaw Lane, Heyside



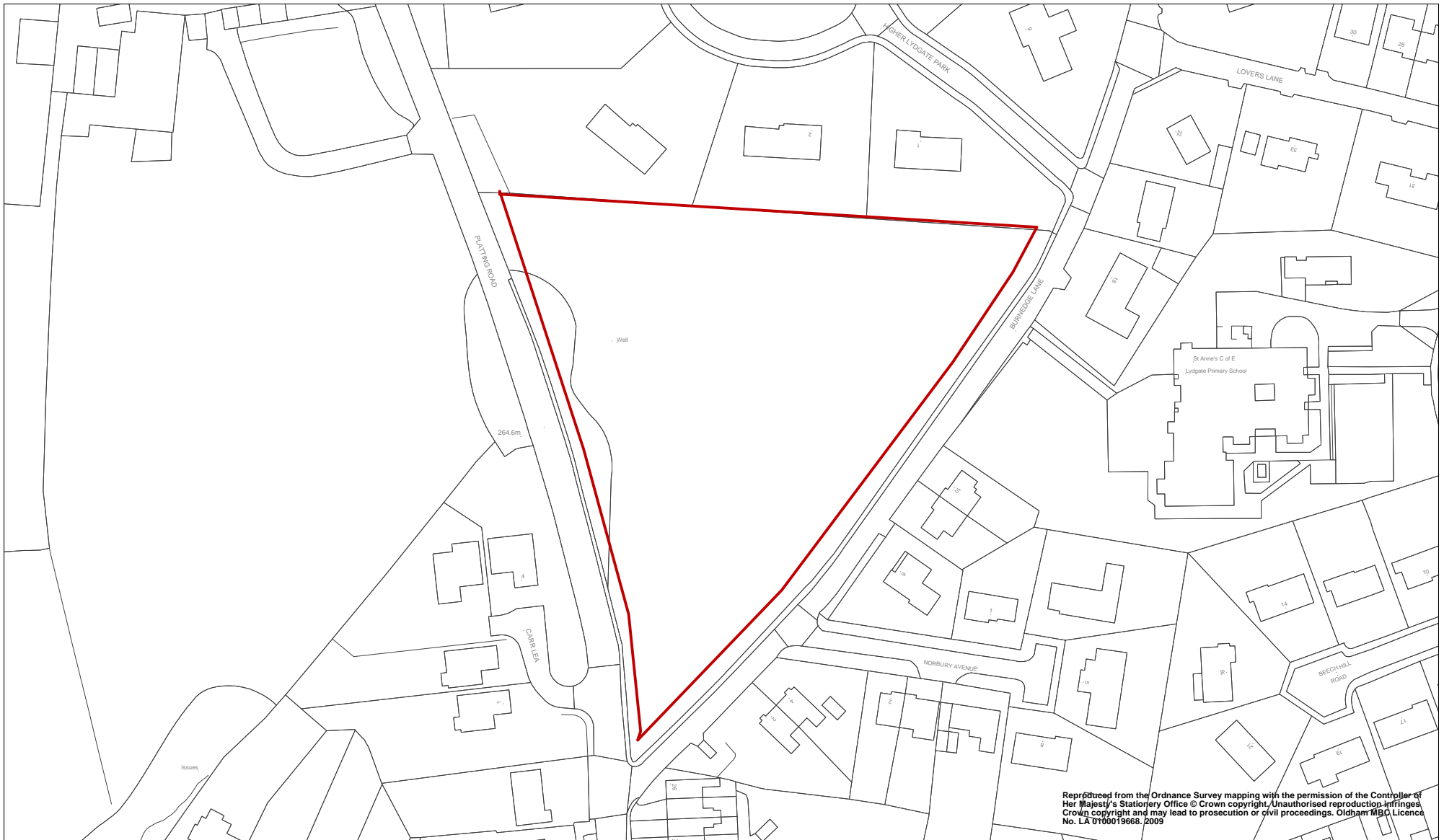

Reproduced from the Ordnance Survey mapping with the permission of the Controller of Her Majesty's Stationery Office © Crown copyright. Unauthorised reproduction infringes Crown copyright and may lead to prosecution or civil proceedings. Oldham MBC Licence No. LA 0100019668, 2009

2006 UDP Policy CF1.1.2 Platting Road, Lydgate

